

S MODULE PREMIUM (fully mounted in the workshop)



IN DETAILS

- Gross area = 20m²
- Length: 8,61m
- Width: 2,4m
- Height: 3m
- Option: Tarrace 14m²



SIZE 20 M²



PERSON 3 / 4

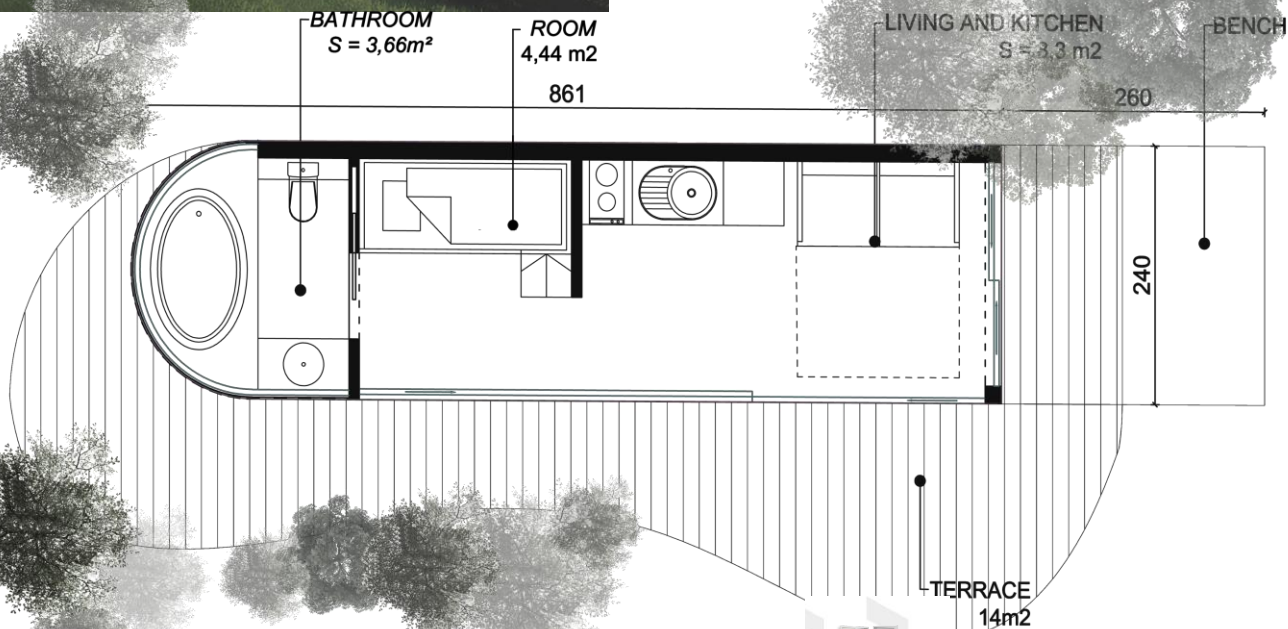

FLOOR

- Steel frame
- Rain membrane
- OSB3 board 8mm
- Wooden joists 60 x 140mm
- + mineral wool insulation 100mm
- Vapour barrier
- OSB3 board 18mm
- Laminate parquet on underlay, vinyl flooring in bathroom



ROOF

- EPDM membrane
- OSB3 board 18mm
- Wooden structure 40 x 160mm
- Mineral wool insulation 150mm
- Vapour barrier
- Wood paneling spruce 12mm
- 2 layers of wood protector



WALLS

- Oil treatment
- Red cedar cladding 17 x 130mm
- Spacers 25 x 50mm
- Counter batten 10 x 40mm
- Wind membrane
- OSB3 board 10mm
- Wooden structure 40 x 100mm
- + mineral wool insulation 100mm
- Vapour barrier
- Wood paneling spruce 12mm
- 2 layers of wood protector



DOORS AND WINDOWS

Entrance sliding doors and windows in aluminium.



EQUIPMENT

- Kitchen furniture
- Bathroom equipment
- Water heater 50L
- Electric radiator



ELECTRICITY AND PLUMBING

Complete electrical and hydraulic installations (depending on version equipment). Lighting included.