

**S MODULE BASIC** (fully mounted in the workshop)

**IN DETAILS**

- Gross area = 20m<sup>2</sup>
- Length: 6,65m
- Width: 3m
- Height: 3m
- Option: Tarrace 3,6m<sup>2</sup>



SIZE 20 M2



PERSON 2 / 3



**LIVING ROOM**  
S = 6,1m<sup>2</sup>

**BATHROOM**  
S = 2,4 m<sup>2</sup>

**KITCHEN**  
S = 5 m<sup>2</sup>

**BEDROOM**  
S = 3,9 m<sup>2</sup>



**FLOOR**

- Steel frame
- Rain membrane
- OSB3 board 8mm
- Wooden joists 60 x 140mm
- + mineral wool insulation 100mm
- Vapour barrier
- OSB3 board 18mm
- Laminate parquet on underlay

W1  
160 x 100

**TERRACE**  
S = 3,6m<sup>2</sup>

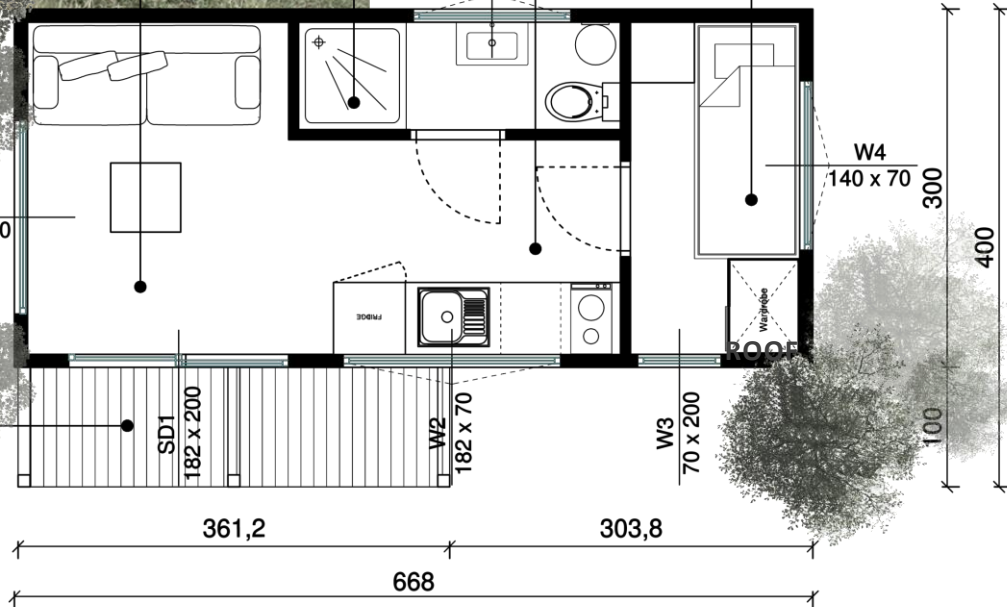

**WALLS**

- Saturator treatment
- Spruce cladding 18 x 130mm
- Spacers 25 x 50mm
- Counter batten 10 x 40mm
- Wind membrane
- OSB3 board 10mm
- Wooden structure 40 x 60mm
- + mineral wool insulation 50mm
- Vapour barrier
- Wood paneling spruce 12mm
- 2 layers of wood protector



**ROOF**

- EPDM membrane
- OSB3 board 18mm
- Wooden structure 40 x 160mm
- Mineral wool insulation 150mm
- Vapour barrier
- Wood paneling spruce 12mm
- 2 layers of wood protector



**ELECTRICITY AND PLUMBING**

Complete electrical and hydraulic installations (depending on version equipment). Lighting included.



**DOORS AND WINDOWS**

Entrance sliding door and windows in aluminium



**EQUIPMENT**

- Kitchen furniture
- Bathroom equipment
- Water heater 50L
- Electric radiator